

**VRD - VARITHERM® ROUND DIFFUSER**

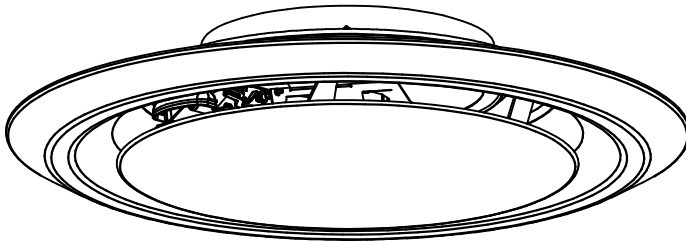
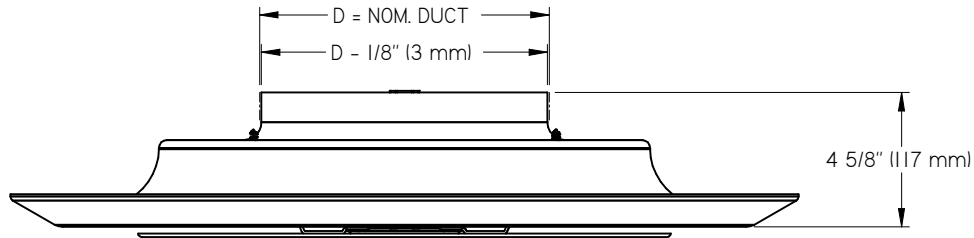

**NOMINAL DIAMETER:**

- 24"
- 600mm

**NOMINAL DUCT SIZE:**

- 6" (152mm)     10" (254mm)
- 8" (203mm)     12" (305mm)

**STANDARD CONSTRUCTION:**

- STEEL CONSTRUCTION

**OPERATION:**

- HC - VAV HEATING AND COOLING
- C - VAV COOLING ONLY
- RA - MATCHING RETURN

**FINISH:**

- B12 - WHITE  
(OPTIONAL FINISHES AVAILABLE)

**NOTES:**

- FACTORY TOLERANCE ±1/16" (2mm)
- STANDARD RANGE: 70 TO 78°F (21 TO 26°C)
- FACTORY DEFAULT SETTINGS: 74°F (23°C)

**OPTIONAL REMOTE ADJUST:**

- DISPL - DISIO DISPLAY, MASTER UNIT (REQUIRES 24VAC POWER INPUT)
- DA - SECONDARY UNIT, RESPONDS TO SIGNAL FROM DISPL MASTER UNITS

**OPTIONS:**

- HB - HANGER BRACKETS  
HANGER BRACKETS  
2 PLACES

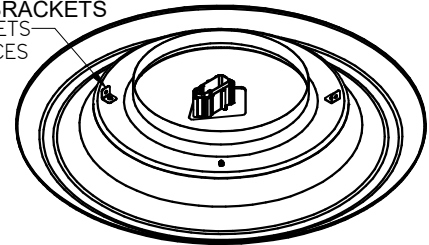

- PRC - PRESSURE RELIEF COLLAR (SHIPPED LOOSE)  
(ALSO SEE SUBMITTAL 268238)

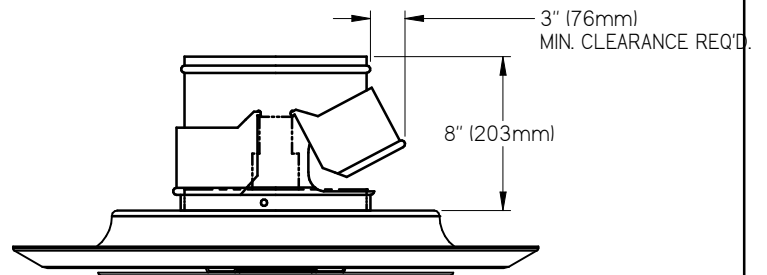

ALL METRIC DIMENSIONS ( ) ARE SOFT CONVERTED. IMPERIAL DIMENSIONS ARE CONVERTED TO METRIC AND ROUNDED TO THE NEAREST MILLIMETER.

<b>PROJECT:</b>		<b>PRICE</b>	
<b>ENGINEER:</b>		<i>NS</i>	<b>VRD</b>
<b>CUSTOMER:</b>		<b>275134</b>	VARITHERM® ROUND DIFFUSER
<b>SUBMITTAL DATE:</b>	<b>SPEC. SYMBOL:</b>	JAN 2023	

**VRD - VARITHERM<sup>®</sup> ROUND DIFFUSER**

**BORDER OPTION**

BV - BEVELLED FRAME  
RECOMMENDED FOR EXPOSED DUCT AND  
HARD CEILING APPLICATIONS

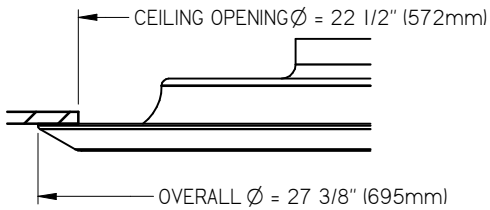

FL - FLAT FRAME  
RECOMMENDED FOR EXPOSED DUCT AND  
T-BAR\* CEILING APPLICATIONS

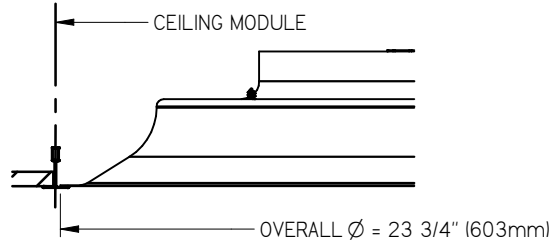

\* T-BAR ADAPTER FRAME FOR T-BAR CEILING SOLD SEPARATELY

ALL METRIC DIMENSIONS ( ) ARE SOFT CONVERTED. IMPERIAL DIMENSIONS ARE CONVERTED TO METRIC AND ROUNDED TO THE NEAREST MILLIMETER.

<b>PROJECT:</b>		<b>PRICE</b> <sup>®</sup>	
<b>ENGINEER:</b>		<i>NS</i>	<b>VRD</b>
<b>CUSTOMER:</b>		<b>275134</b>	VARITHERM <sup>®</sup> ROUND DIFFUSER
<b>SUBMITTAL DATE:</b>	<b>SPEC. SYMBOL:</b>	JAN 2023	